

CONSTRUCTION ISSUE

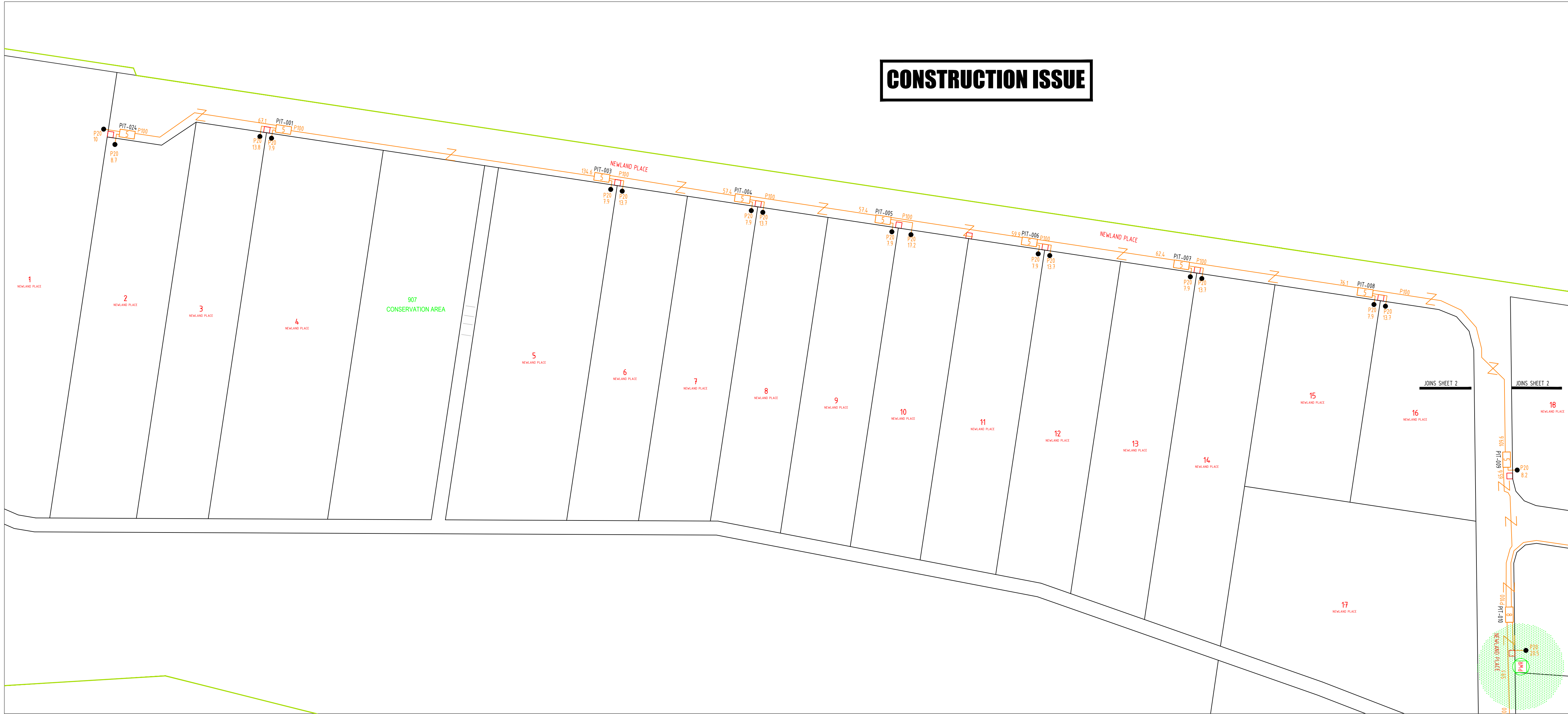

NBN SYMBOL LEGEND

- Transformer / Kiosk / Pad Mount Sub-station / Pole Mount Transformer
- PIT-ID 5 Network Boundary/Local Network Pit (Single Lid) (700mmX450mmX650mm)
- PIT-ID 8 Distribution/Local Network Connection Pit (1360mmX555mmX860mm)
- PIT-ID 9 Fibre Distribution Hub (FDH) Pit (2000mmX555mmX900mm)
- Shared Trench Symbol
- Energex Pillar

TRENCH SECTION

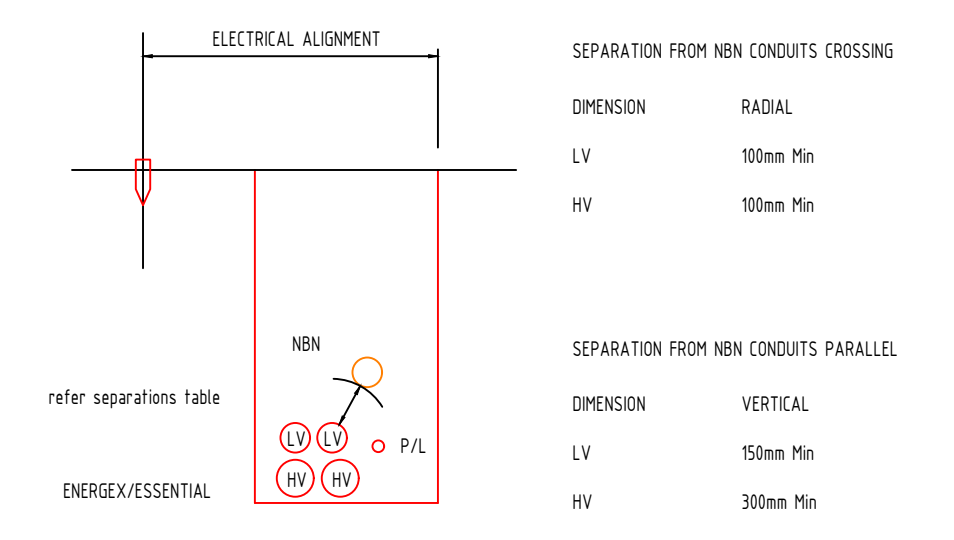

CONDUIT CONFIGURATION

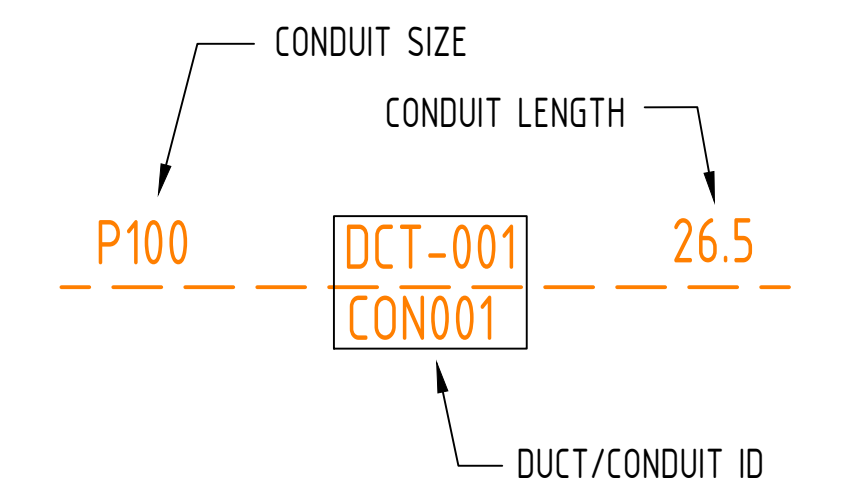

STANDARD NBN PIT OFFSET TO ENERGEX PILLAR

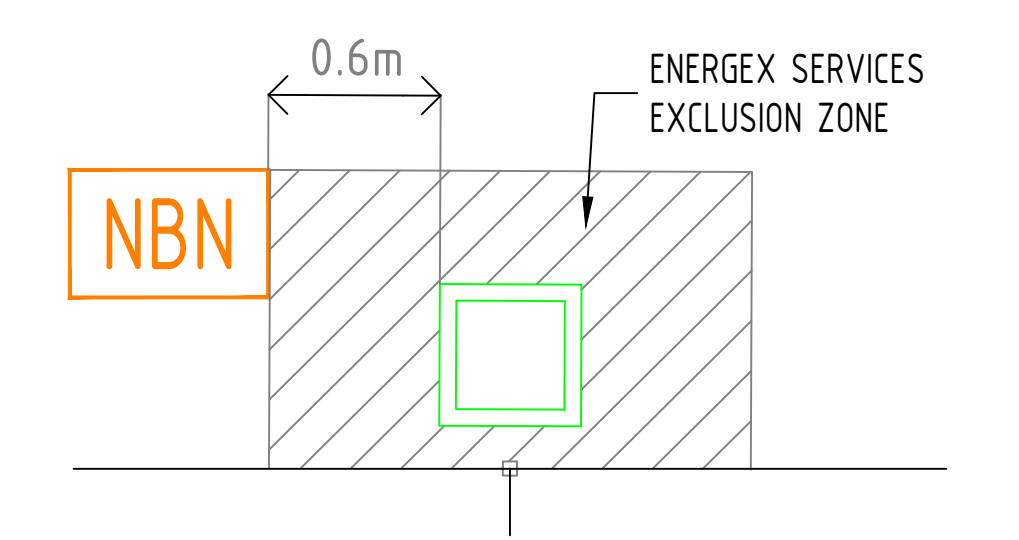

WHERE PITS ARE NOT LOCATED BESIDE PILLARS, OFFSETS WILL BE SHOWN ON THE LAYOUT TO THE NEAREST TRUNCATION. IF NO OFFSET DISTANCE IS SHOWN, PLEASE CONTACT DESIGN CONSULTANT PRIOR TO INSTALLATION.

SDU Development Information
 Development Name: Park Lake - Stage 4 & 5
 Developer Company: PEET LTD
 Development Address: Adare Road
 Authorised Rep: PE CONSULTING ENGINEERS
 Phone: 07 5596 1425
 E-Mail: atilap@pece.com.au
 nbn Reference Number: STG-M000165234
 Stage Number: 4 & 5
 Design Revision: B

BILL OF MATERIAL
 NO OF LOTS: 38

PITS		DUCTS		
SIZE	QTY	SIZE	QTY	MTRS
2	3	P100	24	1818.5
5	19	P50	3	73.4
6	0	P20	38	415.2
8	4			
9	0			

TOTAL NUMBER OF PITS: 26
 TOTAL NUMBER OF MANHOLES: 0
 TOTAL NUMBER OF CONDUITS: 65
 TOTAL LENGTH OF CONDUITS: 2307.1



REV	DATE	DRAFTER	DESCRIPTION	APPROVED
B	18.09.2024	AI	ISSUED FOR CONSTRUCTION	
A	21.06.2024	AI	ISSUED FOR NBN APPROVAL	

STRICTLY CONFIDENTIAL

NBNCO APPROVAL RECORD:

SIGNATURE	DATE
<input type="checkbox"/> DD	_____
<input type="checkbox"/> WD	_____
<input type="checkbox"/> AB	_____

QUALITY RECORD:

NBNCO DISCLAIMER
 THIS DOCUMENT HAS BEEN PREPARED SOLELY FOR THE USE OF NBNCO LIMITED (ABN 86 136 533 741) FOR USE IN MAINTAINING NBNCO FACILITIES. IT HAS NOT BEEN CREATED FOR ANY OTHER USE. IT SHOULD NOT BE SCALED TO LOCATE NBNCO ASSETS. NO WARRANTY IS GIVEN THAT THE INFORMATION IS ACCURATE OR COMPLETE.

nbn Australia's broadband network

PE CONSULTING ENGINEERS

STREET ADDRESS: U14, 39 Lawrence Dr, Naring QLD 4211
 POSTAL ADDRESS: PO Box 2853, Naring QC QLD 4211
 TELEPHONE: (07) 5596 1425
 EMAIL: info@pece.com.au
 WEB: pece.com.au

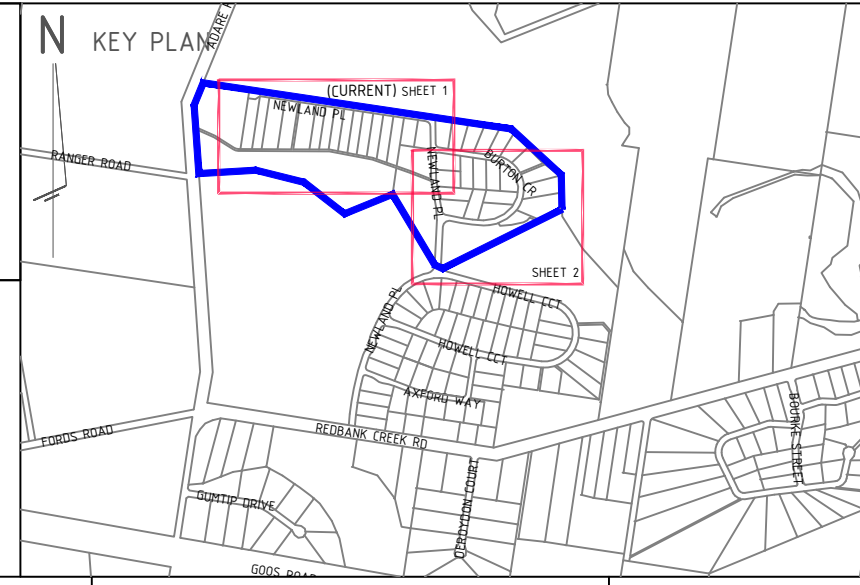

DRAWING TITLE: STG-M000165234
 PIT & PIPE LAYOUT
 39 LOT SUBDIVISION
 PARK LAKE STAGE 4 & 5
 ENABLE#: 279323

STATE: QLD	REGION: 56	
FSA: _____	SAM: _____	ADA: _____
PROJECT No: STG-M000165234		
CADREF No: _____		
SCALE: 1:1000@A1	SHEET No. 1 OF 2	REV. B

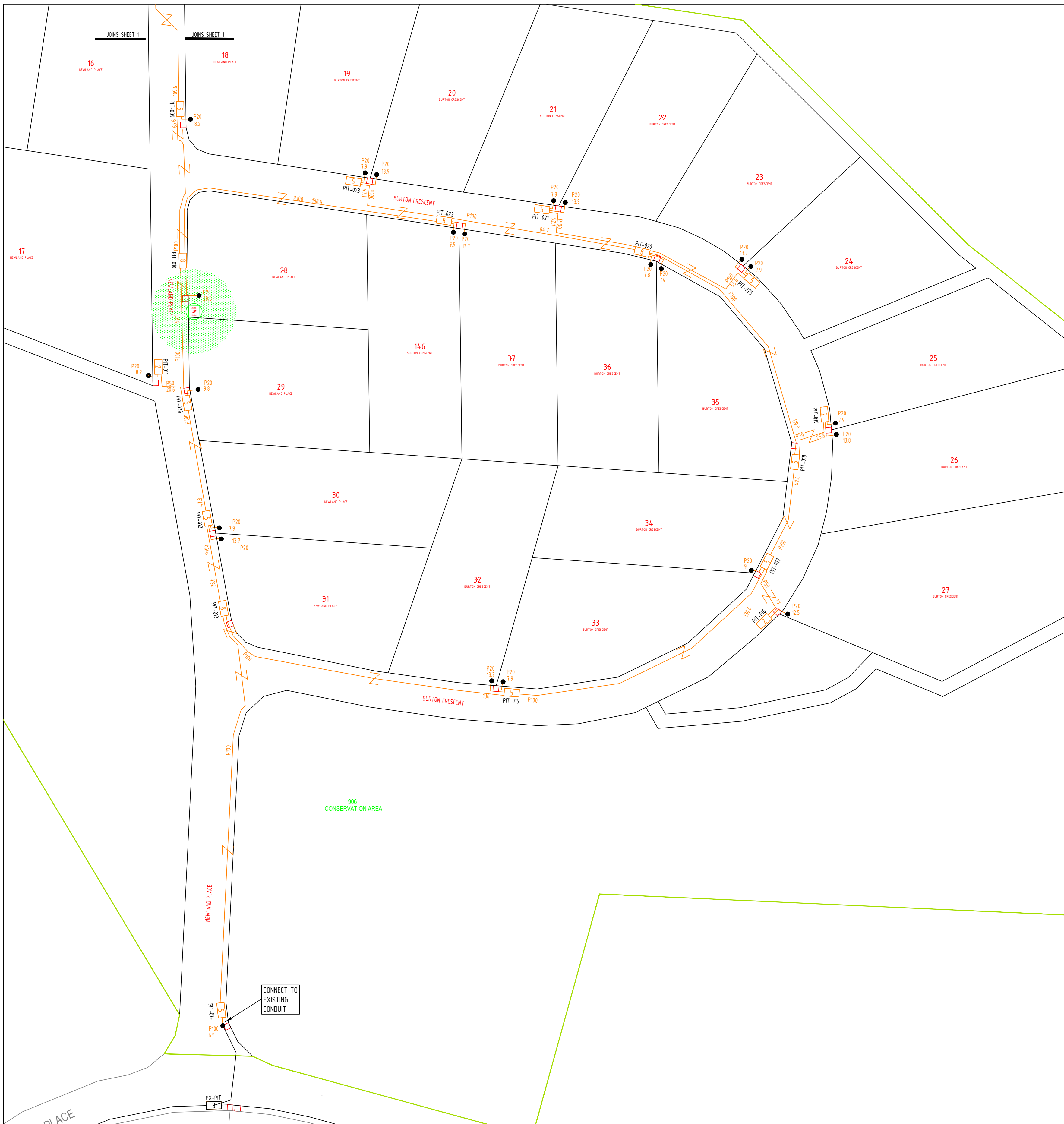

NBN SYMBOL LEGEND

- Transformer / Kiosk / Pad Mount
Sub-station / Pole Mount Transformer
- PIT-ID 5 Network Boundary/Local Network Pit (Single Lid) (700mmX450mmX650mm)
- PIT-ID 8 Distribution/Local Network Connection Pit (1360mmX555mmX860mm)
- PIT-ID 9 Fibre Distribution Hub (FDH) Pit (2000mmX555mmX900mm)
- Shared Trench Symbol
- Energex Pillar

TRENCH SECTION

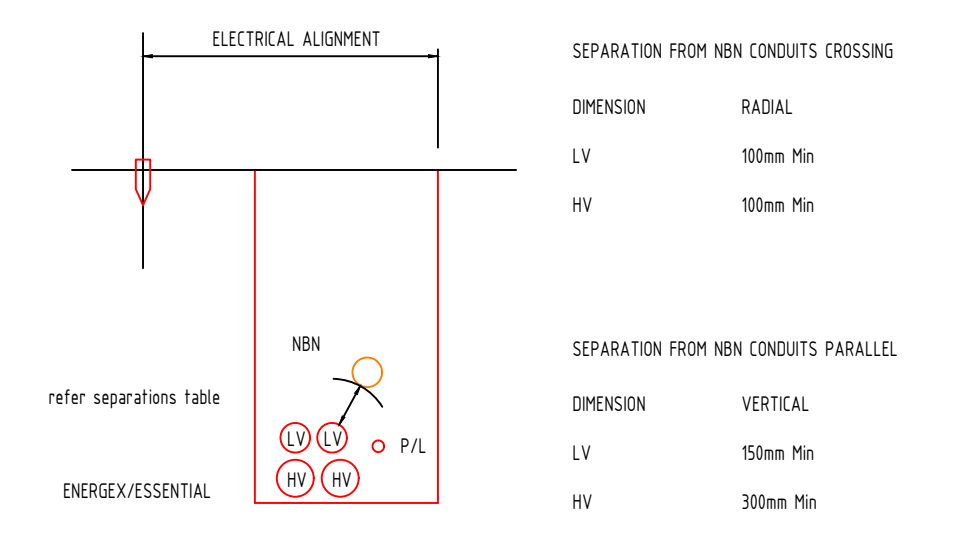

SDU Development Information

Development Name:
Park Lake - Stage 4 & 5

Developer Company:
PEET LTD

Development Address:
Adare Road

Authorised Rep:
PE CONSULTING ENGINEERS
Phone: 07 5596 1425
E-Mail: atilap@pece.com.au

nbn Reference Number: STG-M000165234

Stage Number: 4 & 5
Design Revision: B

BILL OF MATERIAL

NO OF LOTS: 38

PITS		DUCTS	
SIZE	QTY	SIZE	QTY
2	3	P100	24
5	19	P50	3
6	0	P20	38
8	4		
9	0		

TOTAL NUMBER OF PITS: 26
 TOTAL NUMBER OF MANHOLES: 0
 TOTAL NUMBER OF CONDUITS: 65
 TOTAL LENGTH OF CONDUITS: 2307.1

CONDUIT CONFIGURATION

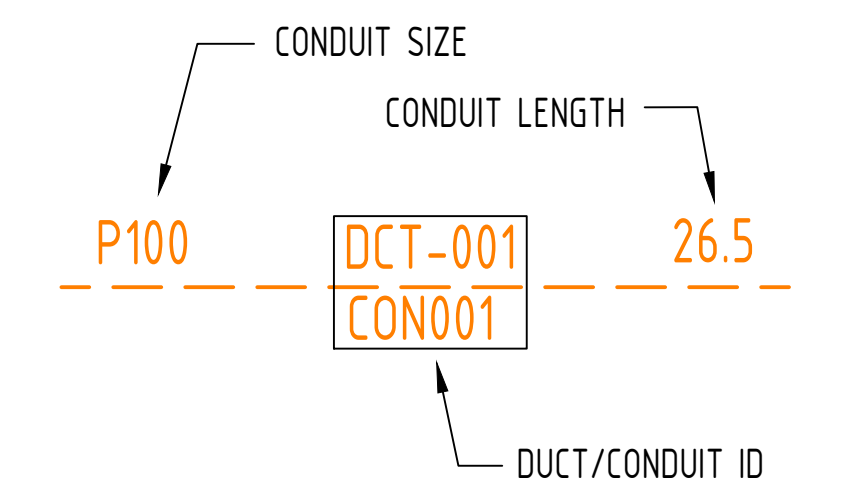

STANDARD NBN PIT OFFSET TO ENERGEX PILLAR

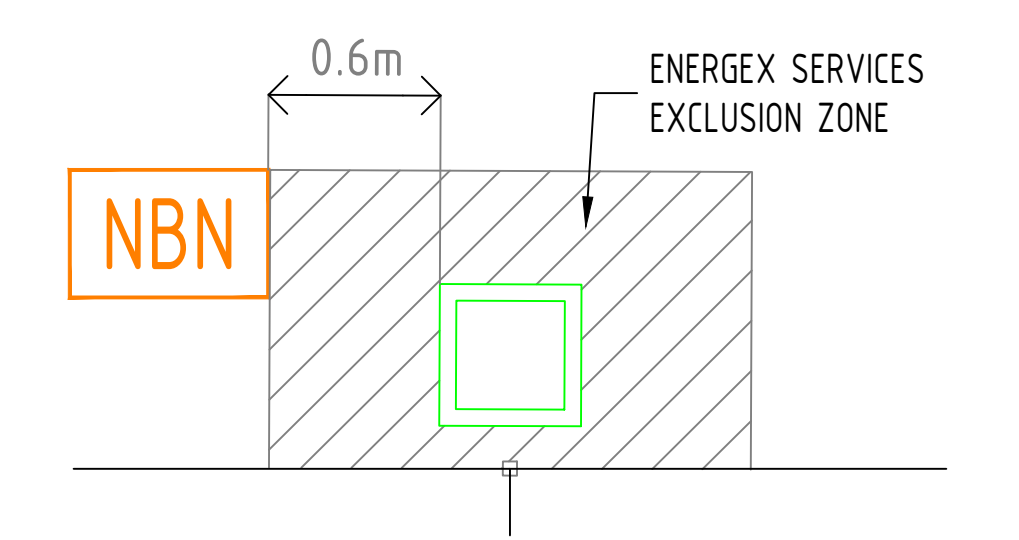

WHERE PITS ARE NOT LOCATED BESIDE PILLARS, OFFSETS WILL BE SHOWN ON THE LAYOUT TO THE NEAREST TRUNCATION. IF NO OFFSET DISTANCE IS SHOWN, PLEASE CONTACT DESIGN CONSULTANT PRIOR TO INSTALLATION.



REV	DATE	DRAFTER	DESCRIPTION	APPROVED
B	18.09.2024	AI	ISSUED FOR CONSTRUCTION	
A	20.06.2024	AI	ISSUED FOR NBN APPROVAL	

STRICTLY CONFIDENTIAL

NBNCO APPROVAL RECORD:

SIGNATURE	DATE
<input type="checkbox"/> DD	_____
<input type="checkbox"/> WD	_____
<input type="checkbox"/> AB	_____

QUALITY RECORD:

NBNCO DISCLAIMER
 THIS DOCUMENT HAS BEEN PREPARED SOLELY FOR THE USE OF NBNCO LIMITED (ABN 86 136 533 741) FOR USE IN MAINTAINING NBNCO FACILITIES. IT HAS NOT BEEN CREATED FOR ANY OTHER USE. IT SHOULD NOT BE SCALED TO LOCATE NBNCO ASSETS. NO WARRANTY IS GIVEN THAT THE INFORMATION IS ACCURATE OR COMPLETE.

PE CONSULTING ENGINEERS
 STREET ADDRESS: U14, 39 Lawrence Dr, Naring QLD 4211
 POSTAL ADDRESS: PO Box 2853, Naring QLD 4211
 TELEPHONE: (07) 5596 1425
 EMAIL: mail@pece.com.au
 WEB: pece.com.au

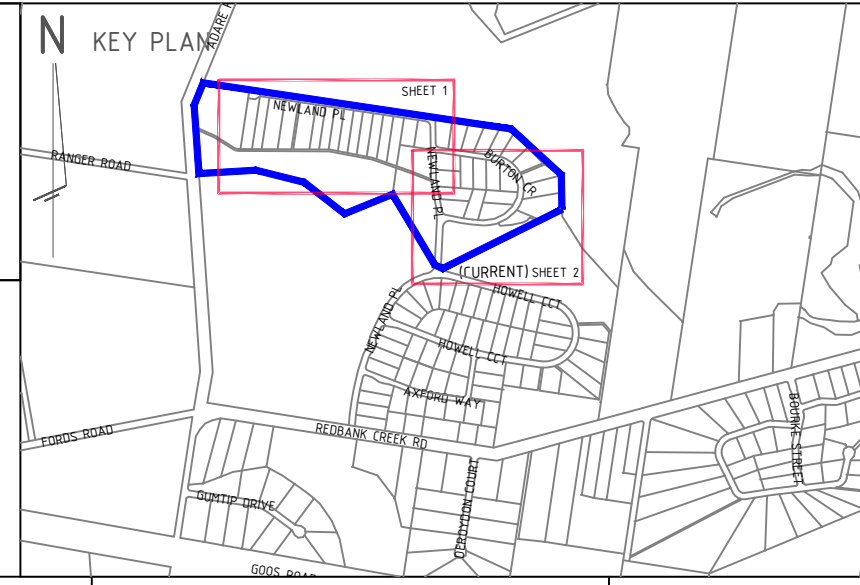

DRAWING TITLE:
STG-M000165234
PIT & PIPE LAYOUT
39 LOT SUBDIVISION
PARK LAKE STAGE 4 & 5
ENABLE#: 279323

STATE: QLD REGION: 56

FSA: SAM: ADA:

PROJECT No: STG-M000165234

CADREF No:

SCALE: 1:1000@A1 SHEET No. 2 OF 2 REV. B